

Backplate Sensor For Governor

BPS-1

Instruction Manual

Thank you for buying a BPS-1 Backplate Sensor for governor. Before using your new sensor, please read this manual together with the instruction manuals of the governor, transmitter, and engine used and use the BPS-1 properly. After reading this manual, store it in a safe place.

- The BPS-1 is designed for use with Futaba GY701, CGY750, and GV-1 governors.
- The BPS-1 can be used only with a BPS-1 compatible engine backplate.

⚠ WARNING

- ❗ Always use the BPS-1 with a BPS-1 compatible engine backplate.
- ❗ Be careful of the connector polarity.
 - Because of the case construction, reversing the polarity may cause trouble or sparking from the wiring.
- ❗ Mount the BPS-1 when the engine is sufficiently cool.
 - If you touch the engine immediately after use, you may receive a burn.
- ❗ Mount the sensor in accordance with the installation method described below.
 - If the BPS-1 drops out during flight, it causes erratic operation or loss of control.

- ❗ Vibration-proof the PC board and mount the BPS-1 where it will not be exposed to fuel and water.
 - Electronic parts are used at the PC board. Take protective measures against vibration, shock, high temperature, and so forth.
- ❗ When mounting the BPS-1 to the fuselage, be sure there is some slack in the wiring cable.
 - If the cable is too tight, vibration may cause the wire to break or the connector to be dislodged and cause a malfunction.
- ❗ Always perform an operation check after assembling.
 - Do not fly until inspection is complete.
- ⊘ Do not use the BPS-1 with anything other than an R/C model helicopter.

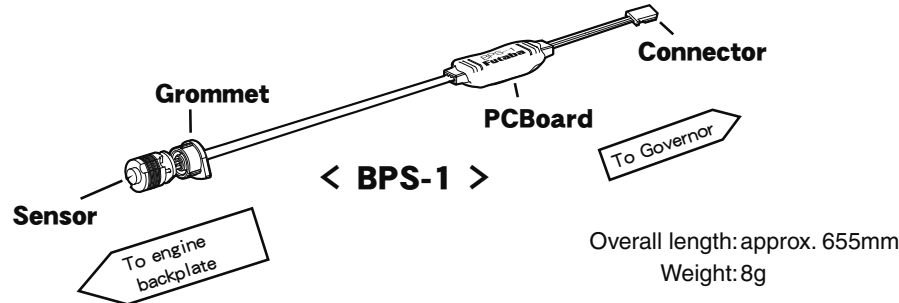

Installation Method

1 Degrease the engine backplate with alcohol, etc.

*Oil residue on the backplate will cause faulty adhesion.

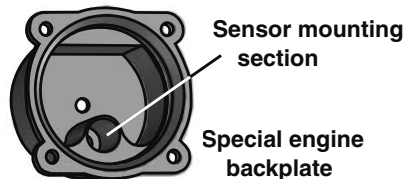

2 Inject silicone resin into the special engine backplate up to about 1/3 (approximately 0.3cc) from the bottom of the sensor mounting section of the backplate.

*Use non-solvent alcohol-release type silicone adhesive.

3 Insert the sensor perpendicularly and push in the grommet fully.

*Until adhesive is squeezed out from the grommet is a sufficient.

4 Wipe off the squeezed out adhesive.

*So that the adhesive does not enter the engine. Adhesive in the engine will cause engine trouble.

5 Fasten the grommet so that it will not move and allow the adhesive to harden.

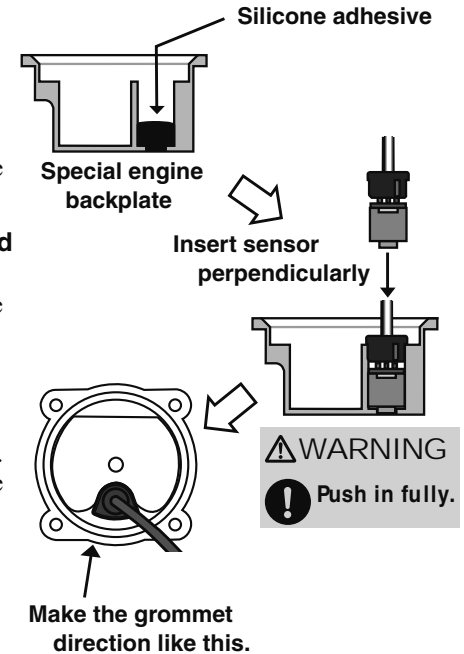

Operation Check

After assembling is complete, check operation as follows:

1 Connect the sensor to the governor used and call the governor revolution sensor test screen. (Revolution sensor monitor for the GV-1.)

*Connect and operate the sensor in accordance with the governor instruction manual.

2 Using a starter, rotate the engine without starting it and check if the sensitivity is 60% or greater.

*Rotate with only the starter without plug heater attached.

*If the sensitivity is less than 60%, re-check the installation.

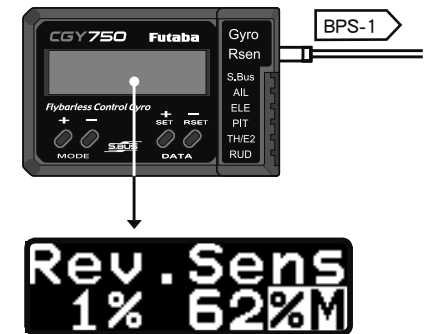

OK at more than 60% by rotating the starter.

FUTABA CORPORATION

oak kandakajicho 8F 3-4 Kandakajicho, Chiyoda-ku, Tokyo 101-0045, Japan

TEL: +81-3-4316-4820, FAX: +81-3-4316-4823

©FUTABA CORPORATION 2018, 5 (2)