

# Futaba

## Digital Servo

# S9254

### CORELESS MOTOR

# S9254

## High Torque Digital Servo for Gyro

- SPEED  
0.06 sec/60° at 4.8V
- TORQUE  
3.4 kgf · cm at 4.8V
- SIZE  
40 × 20 × 36.6 mm
- WEIGHT  
49g
- POWER SUPPLY  
4.8V only

**No dry battery use**

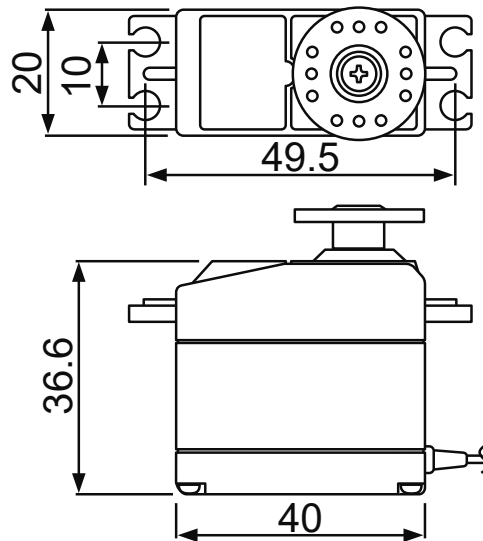

(Unit: mm)

1M23N24625

FUTABA CORPORATION

# Digital Servo Precautions

## WARNING

 **Do not leave the servo in the locked state.** Leaving the servo in the locked state (state in which enough force is applied that the servo cannot move) may cause smoke, fire, and damage.

 **Never connect the battery in reverse.** Reverse connection may cause smoke, fire, and damage.

 **Do not expose the servo to dust and water.** The servo does not have a waterproof construction. If it gets wet, the servo may not operate or the power supply may short circuit.

 **When installing the servo, check PUSHROD LINKAGE to make sure there is no binding** in order to prevent excessive power consumption and decrease the life of the motor and battery.

## CAUTION

 **Do not touch the servo case immediately after servo operation.** You may be burned because the motor and circuits inside the servo become hot.

 **Do not turn the servo horn with unreasonable force.** The servo may be damaged.

 **Do not disassemble or modify the servo.** The servo has a precision construction. Futaba Corp. will not be responsible for any disassembly or modification other than those specified by us.

 **Use the servo as an actuator in hobby applications.** Futaba will not be responsible if the servo is used in applications other than the above.

**Futaba will not be responsible for damage, etc. caused by the use of parts other than Genuine Futaba parts.**

- **Current consumption:** Digital servo is designed to be used with models which require especially high torque and high speed. For this reason, a large current flows during servo operation. Therefore, decide the safe number of uses by paying careful attention to the remaining battery capacity.
- **Power supply:** Use a battery or a voltage regulator with an ample margin as the power supply. The specified performance cannot be displayed with a dry cell battery. For HV servo, use a power supply of ratings 6.0V-7.4V. The specified performance cannot be displayed with a power supply of ratings 4.8V.
- **Applicable models:** Digital servo cannot be used with transmitters (servo neutral signal: 1310 $\mu$ s) manufactured before 1982.
- **System use:** For full performance of digital servos, please use them only with FM, PCM, HRS, and 2.4GHz systems. AM system is not recommended.